

REQUEST FOR REVISION TO THE ZONING MAP

PLEASE PRINT ALL

1. LAWRENCE & MILDRED CLARK
Name - Property Owner
10950 W. HWY 40
Address
ROCHEPORT Mo. 65279
City State/Zip Phone
Potential Buyer/Lessee
Address
City State/Zip Phone

2. Legal Description of land for which revision to zoning map application is made. Please attach copy of Warranty Deed, Deed of Trust, or survey.

Section 10 Township 48 Range 14 SEE ATTACHED.

3. Present zoning and actual land use: CG (VACANT) CELL TOWER

4. Lot/tract size: 6.46 Acres Sq. Ft. 5. Requested zoning district: A-2

6. Adjacent zoning CG/A-2

7. Proposed use should the request to rezone be approved: (Please be as detailed as possible in describing the proposed use)
SINGLE FAMILY RESIDENCE.

8. Reason and justification for the request being submitted:
OWNER WISHES TO HAVE A HOME BUILT FOR HIS DAUGHTER.
WANTS TO RELOCATE C-G TO HWY FRONTAGE

9. Approximate size, use and location of any structure(s):
Existing: NONE Proposed: UNKNOWN AT THIS TIME

10. Type of wastewater system: ON-SITE (LAGOON OR ENCL. SYSTEM)

Application FEE of \$300.00 paid at submission
**If requesting PLANNED ZONING, Review Plan FEE of \$250.00 paid at submission (in addition to application fee)*
***Certified Mailings (\$6.85 per notice, or current certified mailing cost) and Newspaper fees must be paid prior to the Monday before the scheduled meeting.

The above information is true and correct to the best of my knowledge.
Lawrence Clark 7/22/19
Owner's Signature Date Potential Buyer's/Lessee's Signature Date

Representative: (Surveyor, Engineer, Attorney, Etc.)
Crockett Eng
Name Office Phone Number
Address
***Additional fees to be paid by Representative
***Additional fees to be paid by Owner
(If neither are checked bill will be sent to representative)

NOTE: Please attach any additional documentation, sketches, permits, names, and addresses as required as minimum information. Failure to provide any of the required material will result in the invalidation of the application.
Received by: Pauln Adams Date: 7/22/19
Boone County Planning and Building Inspections

TRACT 1

JUL 22 19 11:54 AM

REQUEST FOR REVISION TO THE ZONING MAP

PLEASE PRINT ALL

1. LAWRENCE & MILDRED CLARK Name - Property Owner
10950 W. HWY 40 Address
ROCHEPORT Mo. 65279 City State/Zip Phone
Potential Buyer/Lessee
Address
City State/Zip Phone

2. Legal Description of land for which revision to zoning map application is made. Please attach copy of Warranty Deed, Deed of Trust, or survey.

Section 10 Township 48 Range 14 SEE ATTACHED.

15-200-10-00-006-00

3. Present zoning and actual land use: A-2 (VACANT) CELL TOWER

4. Lot/tract size: 2.55 Acres Sq. Ft. 5. Requested zoning district: C-G

6. Adjacent zoning: C-G/A-2

7. Proposed use should the request to rezone be approved: (Please be as detailed as possible in describing the proposed use)

SINGLE FAMILY RESIDENCE

8. Reason and justification for the request being submitted:

OWNER WISHES TO HAVE A HOME BUILT FOR HIS DAUGHTER.
WANTS TO RELOCATE C-G TO HWY FRONTAGE

9. Approximate size, use and location of any structure(s):

Existing: NONE Proposed: UNKNOWN AT THIS TIME

10. Type of wastewater system: ON-SITE (LAGOON OR ENCL. SYSTEM)

Application FEE of \$300.00 paid at submission
If requesting PLANNED ZONING, Review Plan FEE of \$250.00 paid at submission (in addition to application fee)
***Certified Mailings (\$6.85 per notice, or current certified mailing cost) and Newspaper fees must be paid prior to the Monday before the scheduled meeting.

The above information is true and correct to the best of my knowledge.

Lawrence Clark 7/22/19
Owner's Signature Date Potential Buyer's/Lessee's Signature Date

Representative: (Surveyor, Engineer, Attorney, Etc.)

Crockett Gray
Name Office Phone Number

Address

***Additional fees to be paid by Representative _____
***Additional fees to be paid by Owner _____
(If neither are checked bill will be sent to representative)

NOTE: Please attach any additional documentation, sketches, permits, names, and addresses as required as minimum information. Failure to provide any of the required material will result in the invalidation of the application.

Received by: Paula Lewis Date 7/22/19
Boone County Planning and Building Inspections

TRACT 2

JUL 22 19 11:53 AM



C-G

C-G

2.55 AC.
PROPOSED C-G
ZONING

6.46 Ac.
PROPOSED A-2 ZONING

RNLACHES

A-2

ROYAL
OAKS SUB

ROYAL
OAKS
EAST

A-2

ROYAL
OAKS
SUB

A-2

Kings Ln



N.T.S.

Resource Management Office

0 300ft

Zoning Data: Boone County Resource Management 2019
Parcel and Basemap Data: Boone County Assessor 2019

LARRY CLARK REZONING EXHIBIT
JOB# 190335
7/19/2019

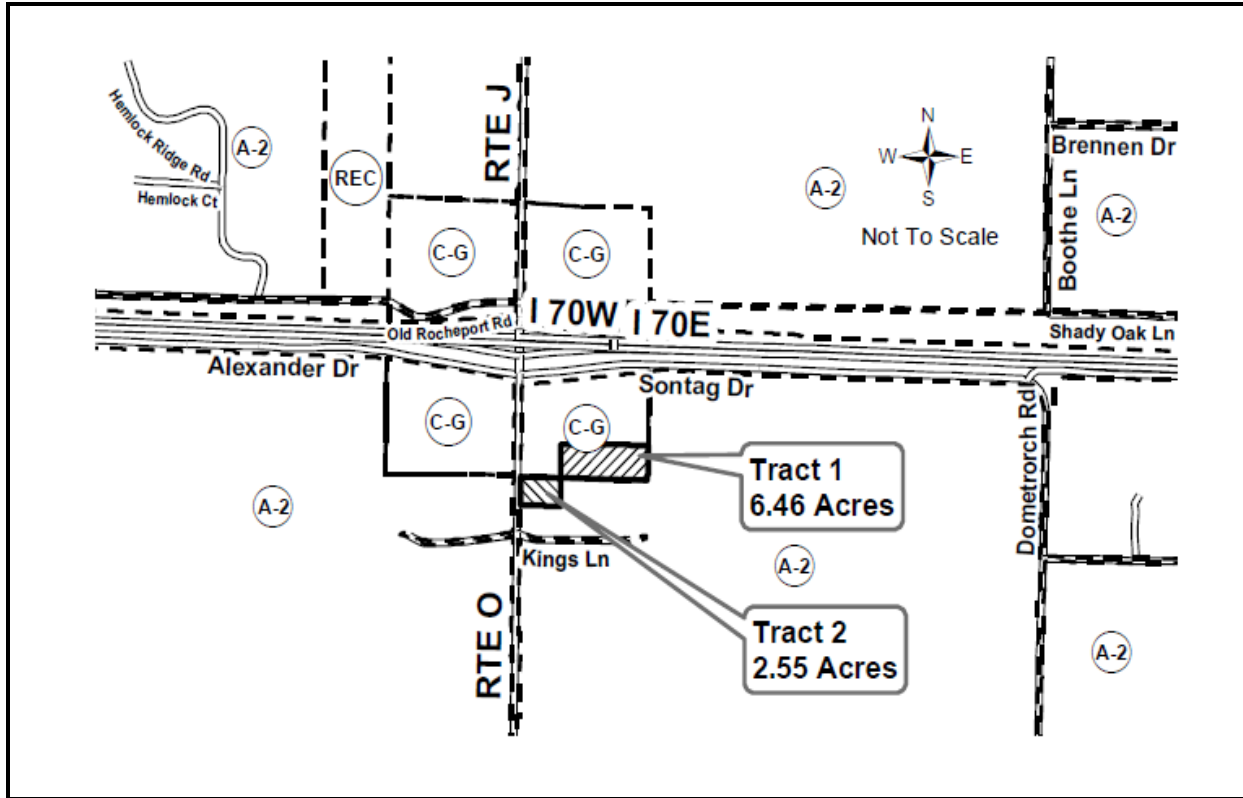

NOTICE OF PUBLIC HEARING BOONE COUNTY, MISSOURI

Notice is hereby given of a public hearing to be held before the Boone County Planning and Zoning Commission at 7:00 P.M. on Thursday, August 15, 2019 and before the Boone County Commission at 7:00 P.M. on Tuesday, August 27, 2019. Both hearings will be held in the Commission Chambers of the Roger B. Wilson Boone County Government Center, 801 E. Walnut St., Columbia, MO. The hearings will give all interested parties an opportunity to be heard in relation to the following:

Request by Lawrence and Mildred Clark to rezone from C-G (General Commercial) to A-2 (Agriculture) on Tract 1 of 6.46 acres; and, from A-2 (Agriculture) to C-G (General Commercial) on Tract 2 of 2.55 acres, located at 950 N Rte O, Rocheport.

Questions regarding the above request may be directed to the Boone County Resource Management office at 886-4330.

Boone County Planning & Zoning Commission
Boyd Harris, Chairperson