



BOONE COUNTY, MISSOURI

Request for Bid #: 35-18JUL19 – Construction of Boone County Support Services Building

ADDENDUM #4 - Issued July 16, 2019

This addendum is issued in accordance with the Request for Bid and is hereby incorporated into and made a part of the Request for Bid Documents. Offerors are reminded that receipt of this addendum **should be acknowledged** and submitted with Offeror's Bid Response.

Specifications for the above noted Request for Bid and the work covered thereby are herein modified as follows, and except as set forth herein, otherwise remain unchanged and in full force and effect.

Questions:

1. Per Soils report it makes reference to 3 to 8' of under cutting for removing undocumented fill in the future building pad area. Will this removal and replace be based on unit prices after the area is stripped and evaluated for unsuitable subgrade before suitable material is imported to make building pad subgrade.

Answer: The Contractor should assume removal and replacement of undocumented fill of 500 cubic yards in the base bid. All other adjustments will be based on unit pricing as documented in the project manual.

Civil Drawings:

1. Grading and Erosion Control to modify existing dam and spillway as shown on attached sheet A4-1.
2. Installation of Turf Reinforcement Mat (Propex Landlok or equivalent) at the location shown on sheet A4-2.
3. Modification of the existing Pond Outlet Structure Orifice per the detail on sheet A4-3.
4. The Site Concrete Joint Locations as approved by Resource Management are shown on sheet A4-

By: 
Melinda Bobbitt, CPPO, CPPB
Director of Purchasing

OFFEROR has examined **Addendum #4** to Request for Proposal# **35-18JUL19 – Construction of Boone County Support Services Building** receipt of which is hereby acknowledged:

Company Name: _____

Address: _____

Phone Number: _____ Fax Number: _____

E-mail: _____

Authorized Representative Signature: _____ Date: _____

Authorized Representative Printed Name: _____

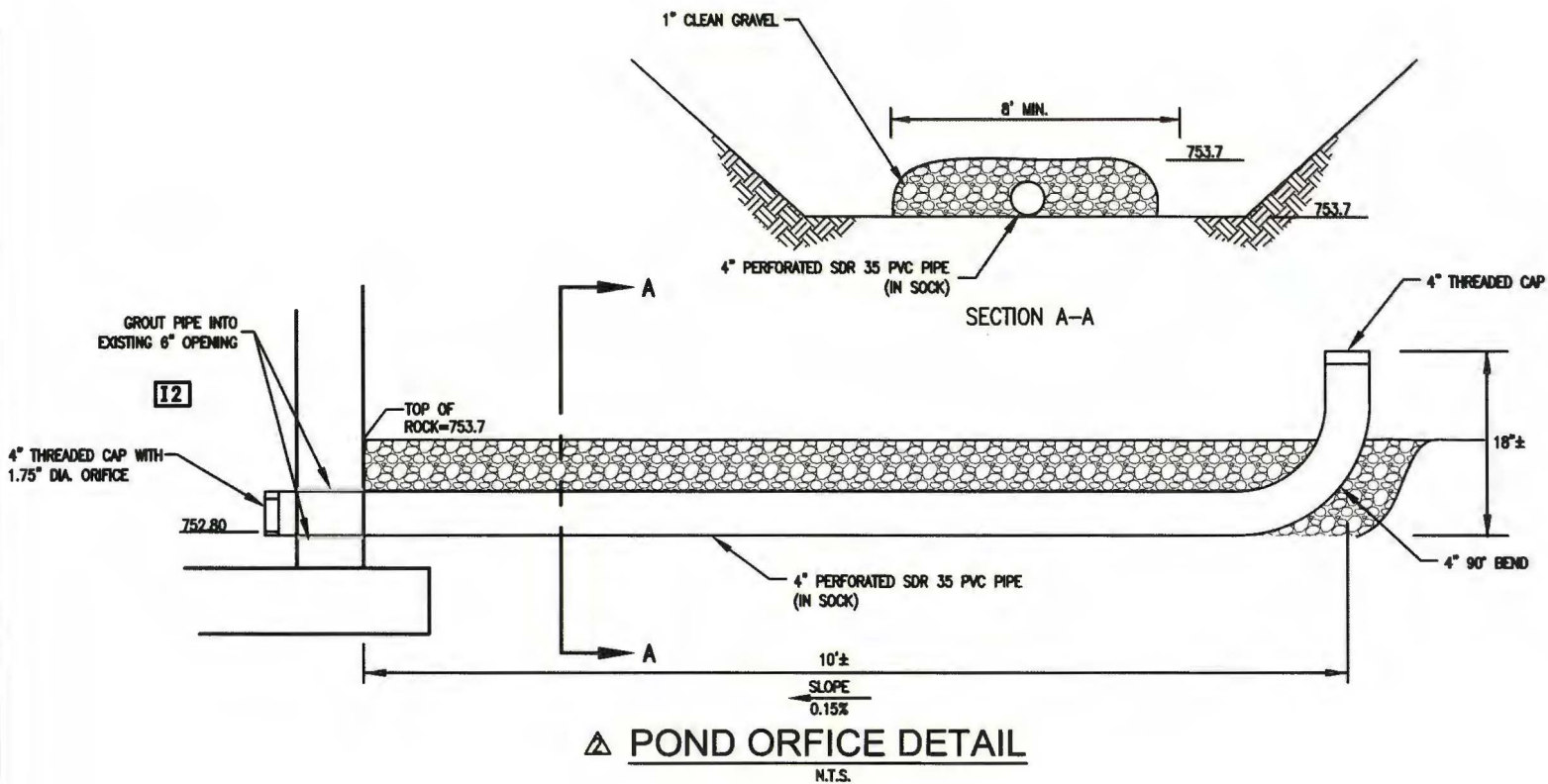

**ALLSTATE
CONSULTANTS**

3312 LEMONE INDUSTRIAL BLVD.
COLUMBIA, MO 65201
(573) 875-8799
allstateconsultants.net

SHEET A4-3

POND OUTLET STRUCTURE ORIFICE MODIFICATION BOONE COUNTY SUPPORT SERVICES BUILDING

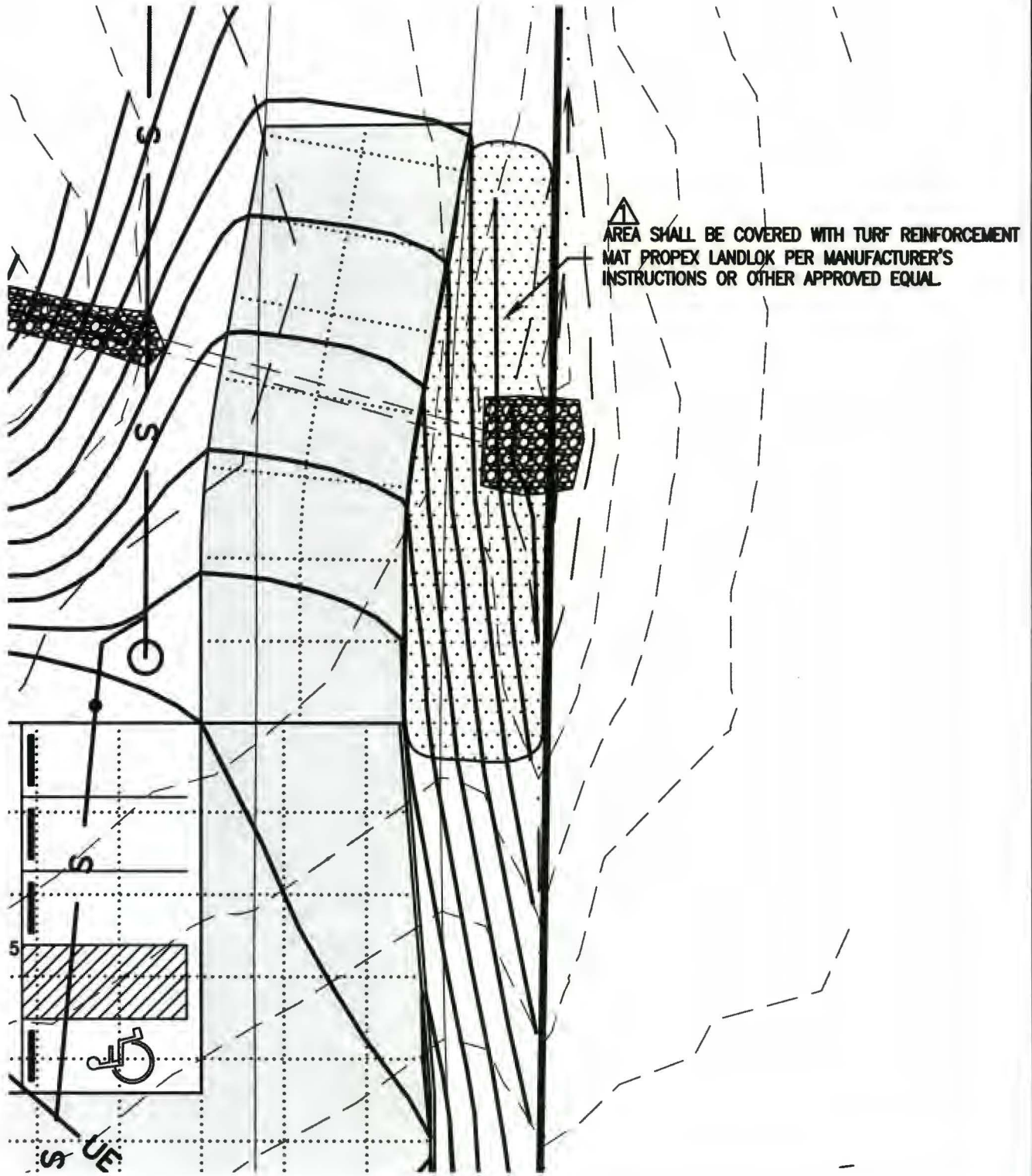

**ALLSTATE
CONSULTANTS**

3312 LEMONE INDUSTRIAL BLVD.
COLUMBIA, MO 65201
(573) 875-8799
allstateconsultants.net

SHEET A4-2
TURF REINFORCEMENT MAT
BOONE COUNTY SUPPORT SERVICES BUILDING

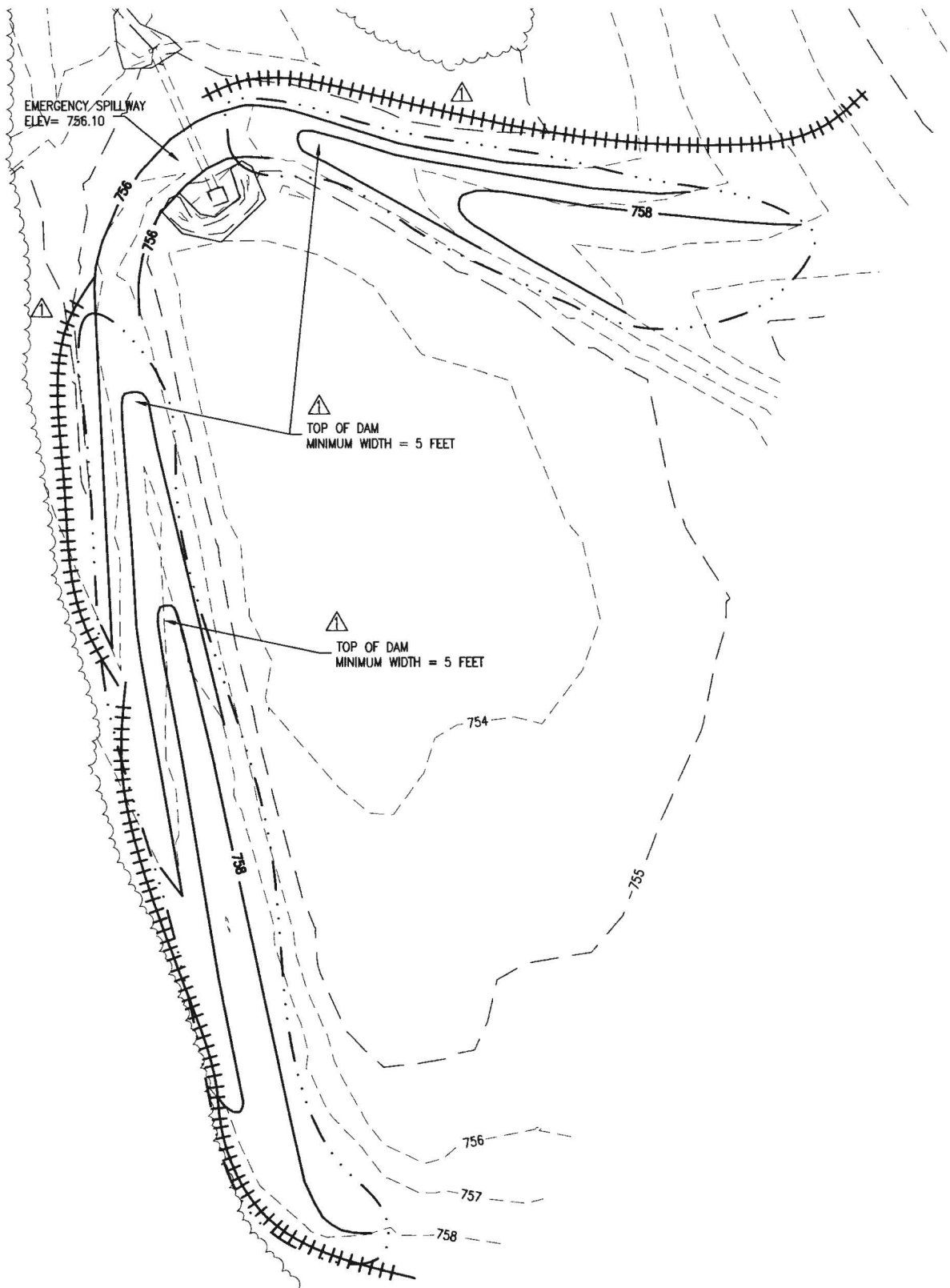

**ALLSTATE
CONSULTANTS**

3312 LEMONE INDUSTRIAL BLVD.
COLUMBIA, MO 65201
(573) 875-8799
allstateconsultants.net

SHEET A4-1

DAM MODIFICATION MODIFICATION

BOONE COUNTY SUPPORT SERVICES BUILDING

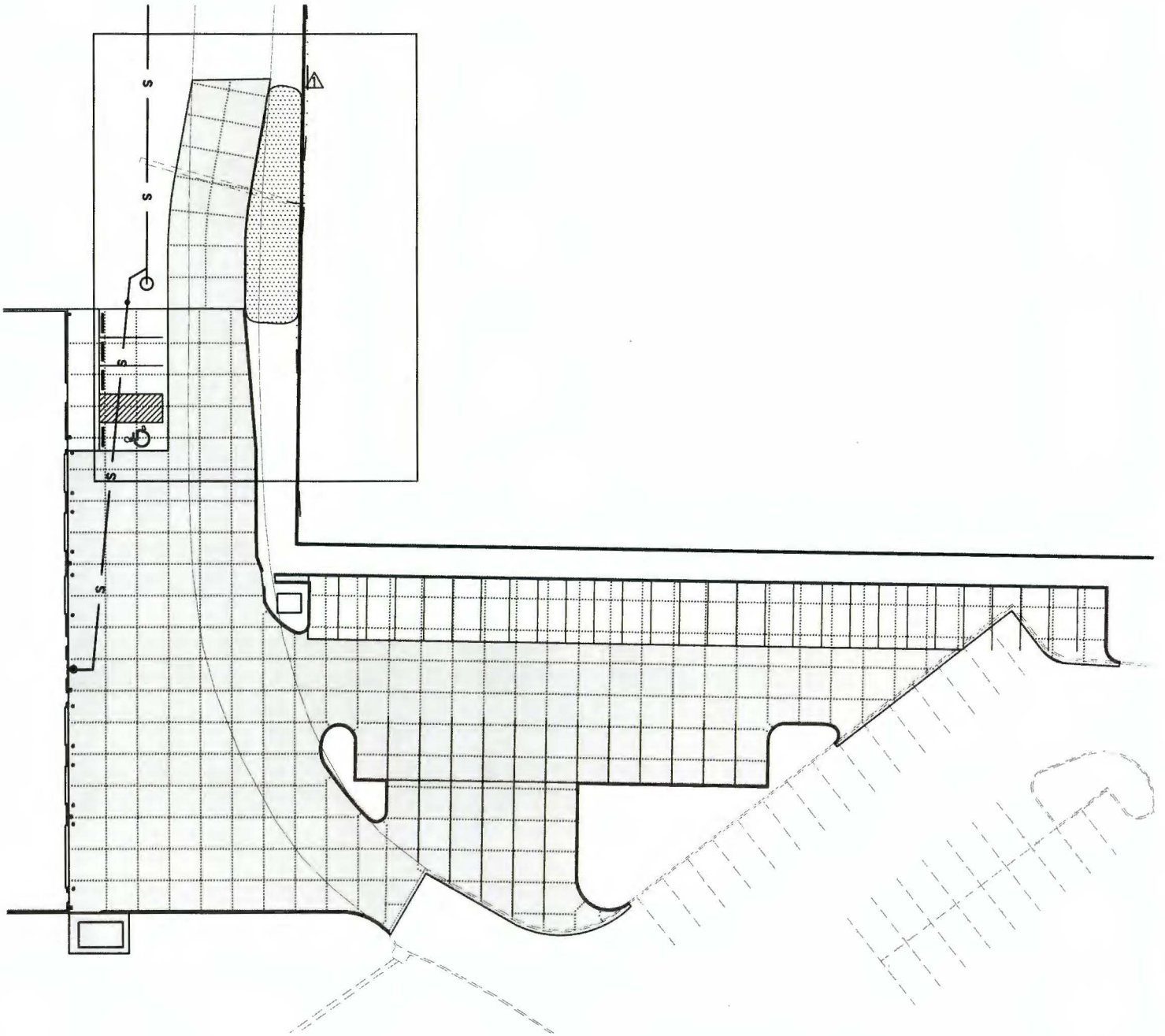

**ALLSTATE
CONSULTANTS**

3312 LEMONE INDUSTRIAL BLVD.
COLUMBIA, MO 65201

(573) 875-8799

allstateconsultants.net

SHEET A4-4
CONCRETE JOINT LOCATIONS
BOONE COUNTY SUPPORT SERVICES BUILDING