

CONTRACT DOCUMENTS  
BOONE COUNTY, MISSOURI  
BID #46-29JUN06 Boone Industrial Park-Road Improvement Project

**ADDENDUM #1**  
(Issued June 22, 2006)

This addendum is issued in accordance with the Introduction and General Conditions of Bidding and is hereby incorporated into and made a part of the Contract Documents. Bidders are reminded that receipt of this addendum should be acknowledged and submitted with bidder's *Response Form*.

Specifications for the above noted Request for Bid and the work covered thereby are herein modified as follows, and except as set forth herein, otherwise remain unchanged and in full force and effect:

**BID DOCUMENTS:**

1. On page 16.1 under SPECIAL PROVISIONS of the Bid Documents, under point #6, add the statement "The 4" of type 1 aggregate shall be incidental to the cost of 7" P.C.C. Pavement."
2. On dwg. C501, sheet 11 of 14 of the plan sheets, detail #3 INTEGRAL ROLL-BACK CURB, change the thickness of the type 1 aggregate from 6" to 4".
3. On dwg. C501, sheet 11 of 14 of the plan sheets, detail #4 INTEGRAL BARRIER CURB, delete in its entirety the note "Type 5 Aggregate" and replace with "Type 1 Aggregate." Also on that dwg., sheet 11 of 14 of the plans sheets, change the thickness of the type 1 aggregate from 6" to 4".
4. CLARIFICATION: The end treatment for the 72" CMP's shall be straight mitered to match the proposed 3:1 slopes in the extension portion of Interstate Drive. The remaining culverts proposed for this project shall have a mitered end section as shown in detail 2 on page C504, sheet 14 of 14 of the plan sheets labeled CMP MITERED END SECTION.
5. On page 15.18 under TECHNICAL SPECIFICATIONS of the Bid Documents, under PART 1 – GENERAL/1.01 SECTION INCLUDES, delete in its entirety the statement "A. Installation of geotextile fabric for reinforcement of subgrade" and replace with "A. Installation of geogrid and geotextile fabric for reinforcement of subgrade."
6. On page 15.18 under TECHNICAL SPECIFICATIONS of the Bid Documents, under PART 1 – GENERAL/1.02 WORK INCLUDED, delete in its entirety the statement "A. Furnishing and placing geotextile fabric for the reinforcement of subgrade" and replace with "A. Furnishing and placing geogrid and geotextile fabric for the reinforcement of subgrade."
7. On page 15.18 under TECHNICAL SPECIFICATIONS of the Bid Documents, under PART 1 – PRODUCTS/2.01 GEOTEXTILE FABRIC, section A, delete the words "granular base" and replace with "geogrid."
8. On page 15.18 under TECHNICAL SPECIFICATIONS of the Bid Documents, under PART 2 – PRODUCTS, add a section "2.02 GEOGRID" and add the following sections:
  - A. Install the geogrid between the geotextile and the granular base as shown in the details of the plans.
  - B. Geogrid will be Tensar BX 1100, Mirafi Miragrid 3XT, or approved equal.
9. On page 16.1 under SPECIAL PROVISIONS of the Bid Documents, add point #7: "Contractor shall provide the means, methods, traffic control, and phasing as a submittal for the County Engineer's review prior to start of construction. The contractor shall allow for continuous access to roadways and property with notification to property owners and tenants 72 hours in advance of their driveway closure. High early strength concrete is permitted on driveways and roadways."
10. The attached drawing listed "ADD #1", which is part of this addendum, shows changes to the design of the southwest corner of the intersection, specifically the radius and the transition to the adjacent driveway.

By:   
Heather Turner, CPPB  
Senior Buyer

BIDDER has examined copy of Addendum #1 to Request for Bid #46-29JUN06 Boone Industrial Park-Road Improvement Project, receipt of which is hereby acknowledged:

Company Name: \_\_\_\_\_

Address: \_\_\_\_\_  
\_\_\_\_\_

Phone Number: \_\_\_\_\_

Fax Number: \_\_\_\_\_

Authorized Representative Signature: \_\_\_\_\_

Date: \_\_\_\_\_

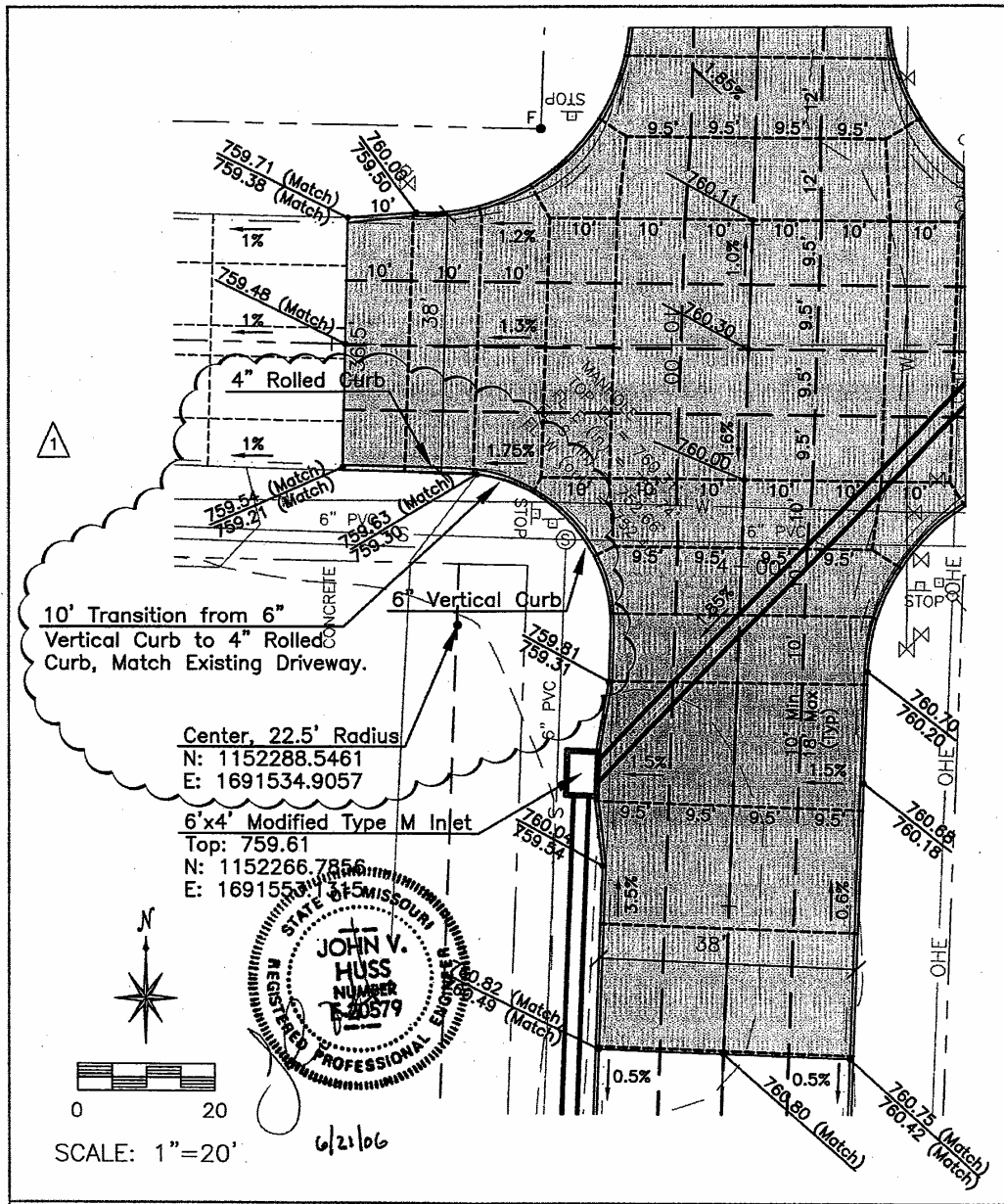

DESIGNED BY: JFS

CHECKED BY: JVH

DRAWN BY: JFS

BOONE COUNTY, MISSOURI  
 BOONE INDUSTRIAL PARK Project No. 06-375



Revisions	
Date:	Description:
06/20/06	ADD #1

SCALE: 1"=20'  
 DATE: 06/20/06  
 ISSUED BY: THHInc  
 REF: C103

ADD #1